

EXISTING TMO LAYOUT

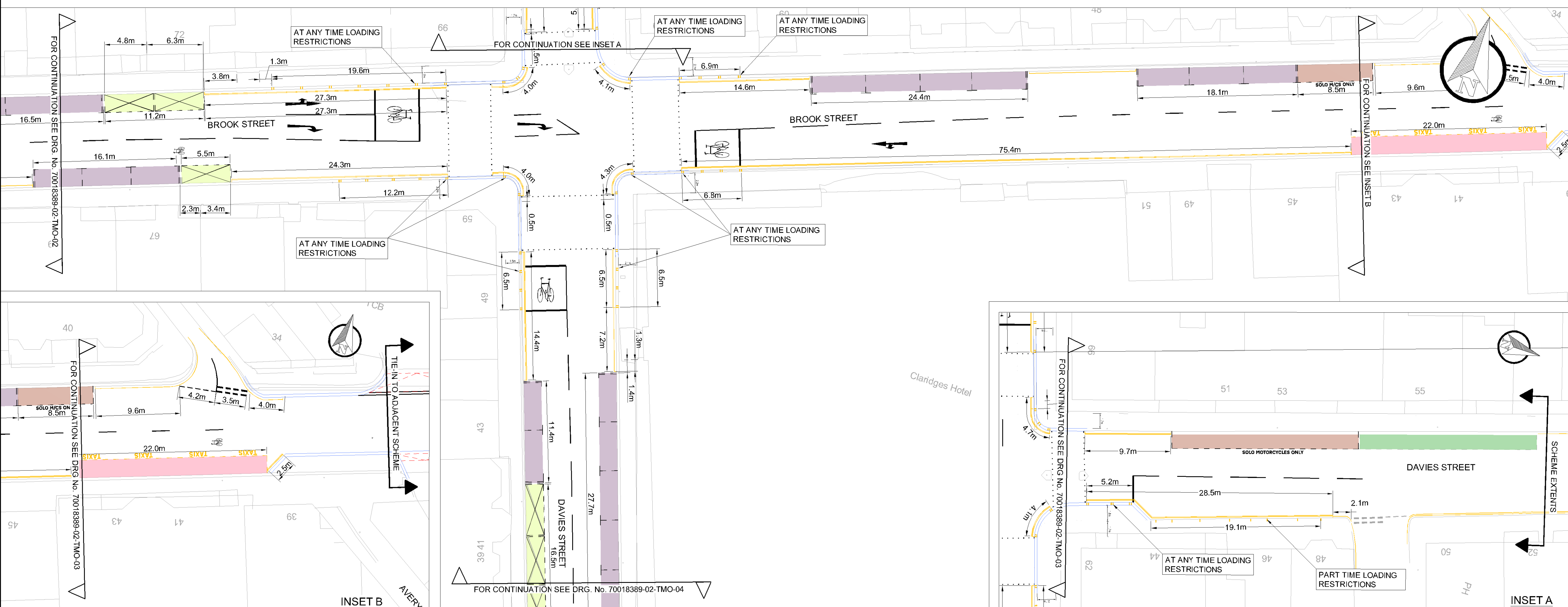

PROPOSED TMO LAYOUT

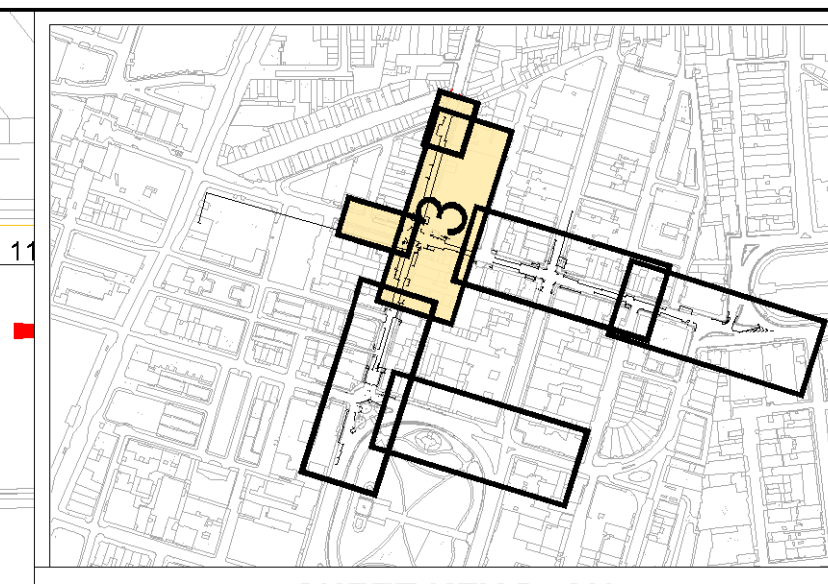

SHEET KEY PLAN

- KEY:
- DIPLOMATIC
 - RESIDENTS ONLY
 - SHARED USE (RESIDENTS & PAY-BY-PHONE)
 - PAY-BY-PHONE BAYS MAX 4 HOURS MON - SAT 8:30AM - 6:30PM
 - CAR CLUB
 - TAXIS
 - MOTORCYCLE BAYS
 - SINGLE YELLOW LINES NO WAITING MON - SAT 8:30AM - 6:30PM
 - SINGLE YELLOW TRANSVERSE KERB MARKINGS NO LOADING: MON - SAT 8:30AM - 6:30PM
 - DOUBLE YELLOW LINES NO WAITING AT ANY TIME
 - DOUBLE YELLOW TRANSVERSE KERB NO LOADING MARKINGS AT ANY TIME
 - PROPOSED ROAD MARKINGS
 - DIRECTION OF EXISTING VEHICULAR MOVEMENTS
 - NO CHANGE TO EXISTING SINGLE YELLOW LINES
 - NO CHANGE TO EXISTING DOUBLE YELLOW LINES

REV	DATE	BY	DESCRIPTION	CHK	APP
E	07.03.2017	MFC	MINOR AMENDMENTS FOLLOWING REVIEW	DA	MK
D	26.01.2017	AS	DOUBLE YELLOW LINES OUTSIDE CLARGES	DA	MK
C	23.01.2017	AS	UPDATED FOLLOWING TMO CONSULTATION	DA	MK
B	24.11.2016	MVB	ISSUED FOR CLIENT REVIEW	JS	JN
A	05.11.2016	MVB	ISSUED FOR CLIENT REVIEW	DA	JN

DRAWING STATUS

DETAILED DESIGN

25 Mandela Way, London, SE1 5SZ
www.fonway.co.uk www.wspgroup.com

CLIENT

City of Westminster

PROJECT

BROOK STREET/ DAVIES STREET TWO-WAY & GROSVENOR SQUARE & DAVIS ST. PARKING CHANGES

TITLE

TRAFFIC MANAGEMENT ORDER LAYOUT PLAN SHEET 3 OF 5

SCALE @ A1	DATE	DESIGNED BY	CHECKED	APPROVED	SHEET
1:250	09-11-2016	LMB/MB	DA	JN	A1
JOB No.	FMC PROJECT No.	BREF/DBS No.			
70018389	TBC	TBC			
DRAWING No.				REV.	
70018389-03-TMO-03				E	